

SCREW TERMINAL TYPE ALUMINUM ELECTROLYTIC CAPACITORS

■ HOW TO ORDER

④ Type of bracket code

Type of bracket code	Bracket
I	Bracket I type
Y	Bracket Y type
X	Bracket X type
B	Stud screw type
IUC	Insulation holder I type
YUC	Insulation holder Y type

⑤ Case dia code

Case dia code	Case dia (mm)
A	36
C	51
D	64
E	77
F	90
G	101
K	121

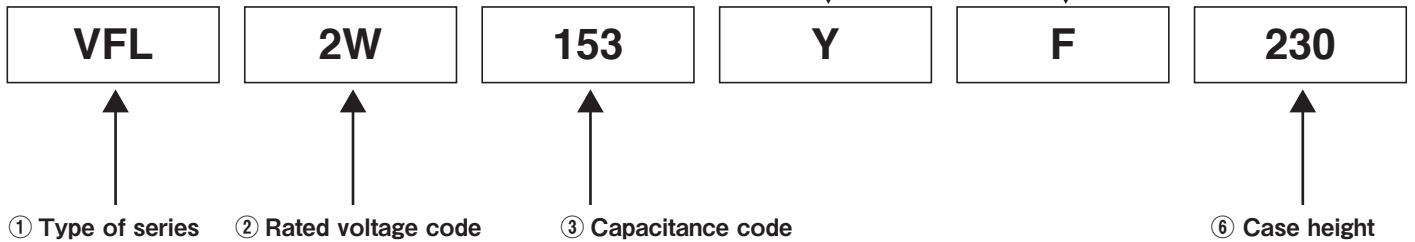

① Type of series

Type of series
VF
VG
VFL
VGL
VFH
VFR
VGR
VFLR
VGLR
VFHR
HCGWA
HCGW2
HCGW3
FXW
FXW2

② Rated voltage code

Rated voltage code	Rated voltage (V)
0J	6.3
1A	10
1C	16
1E	25
1V	35
1H	50
1J	63
1K	80
2A	100
2C	160
2D	200
2E	250
2V	350
2G	400
2W	450
2H	500
2L	550
600V	600

③ Capacitance code

Capacitance code	Capacitance (μF)	Capacitance code	Capacitance (μF)
271	270	822	8,200
331	330	103	10,000
391	390	123	12,000
471	470	153	15,000
561	560	183	18,000
681	680	223	22,000
821	820	273	27,000
102	1,000	333	33,000
122	1,200	393	39,000
152	1,500	473	47,000
182	1,800	683	68,000
222	2,200	104	100,000
272	2,700	154	150,000
332	3,300	224	220,000
392	3,900	334	330,000
472	4,700	474	470,000
562	5,600	564	560,000
682	6,800	684	680,000

⑥ Case height

The first two digits are significant.

The last digit indicates the number of following zeros.

SCREW TERMINAL TYPE ALUMINUM ELECTROLYTIC CAPACITORS

ALUMINUM ELECTROLYTIC CAPACITORS

Assembling method

Bracket(1) is used as the standard.

(Except the external deter of case of $\phi 51 \sim 101$, the Y-type bracket is used as the standard.)

(1) Bracket

I type

Type of bracket code : I

Available dia : Case dia size $\phi 36 \sim 90$

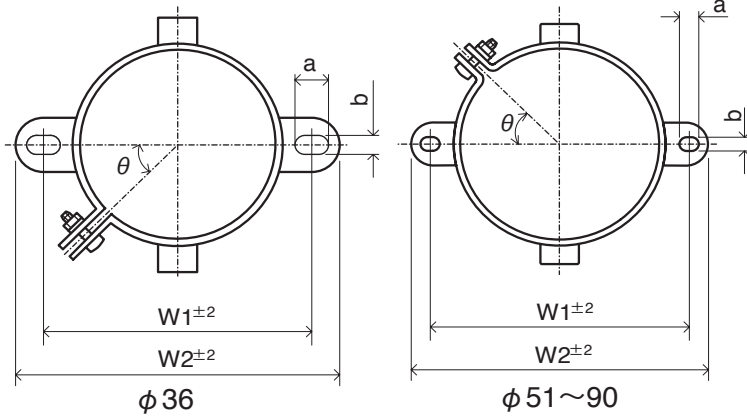

ϕD (mm)	a (mm)	b (mm)	θ ($^{\circ}$)	W1 (mm)	W2 (mm)
36	6.0	3.5	45	48.0	58.0
51	6.0	4.5	45	68.0	80.0
64	6.0	4.5	45	81.0	93.0
77	6.0	4.5	45	93.5	106.0
90	7.0	5.0	30	108.0	120.5

Clamping value of the bracket

ϕD (mm)	Screw size	Recommended torque (permissible) (N·m)
36	M3	0.5 (0.5 ~ 0.6)
51 ~ 90	M4	1.3 (1.0 ~ 1.6)

Y type

Type of bracket code : Y

Available dia : Case dia size $\phi 51 \sim 101$

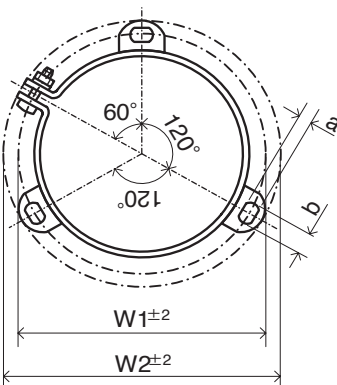

ϕD (mm)	a (mm)	b (mm)	W1 (mm)	W2 (mm)
51	4.5	7	63.5	73.0
64	4.5	7	76.2	85.1
77	4.5	7	88.9	98.4
90	4.5	7	101.6	111.1
101	5.5	8	115.0	127.0

Clamping value of the bracket

ϕD (mm)	Screw size	Recommended torque (permissible) (N·m)
51 ~ 90	M4	1.3 (1.0 ~ 1.6)
101	M5	1.8 (1.5 ~ 2.0)

X type

Type of bracket code : X

Available dia : Case dia size $\phi 121$

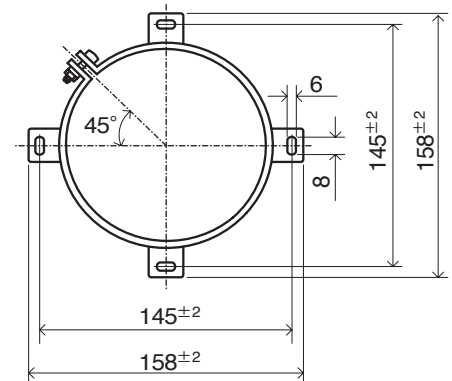

Clamping value of the bracket

ϕD (mm)	Screw size	Recommended torque (permissible) (N·m)
121	M5	1.8 (1.5 ~ 2.0)

(2) Stud screw type

B type

Type of bracket code : B

Available dia : Case dia size $\phi 51 \sim 101$

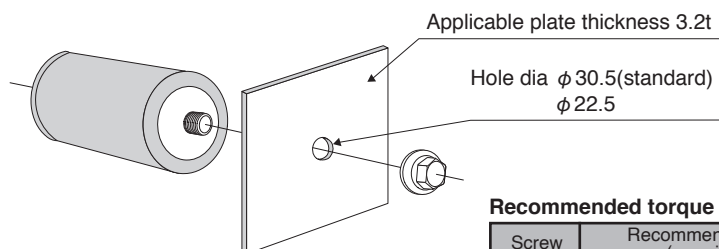
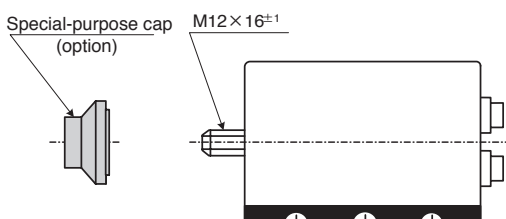

Recommended torque of stud screw

Screw size	Recommended torque (permissible) (N·m)
M12	15

SCREW TERMINAL TYPE ALUMINUM ELECTROLYTIC CAPACITORS

(3) Insulation holder

Best suited for improving insulation and vibration resistance and for cutting back on assembly costs.
Please contact us if this holder is used so that a special aluminum case is necessary.

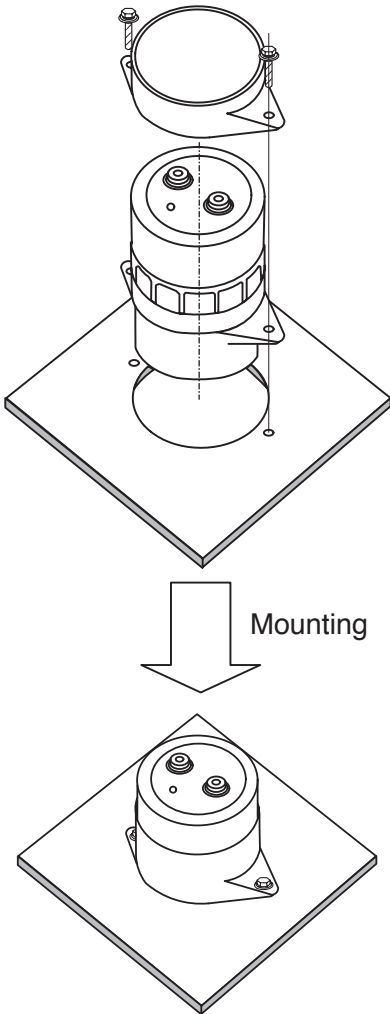

■ I type
Type of bracket code : IUC
Available dia : Case dia size $\phi 77$

■ Y type
Type of bracket code : YUC
Available dia : Case dia size $\phi 90 \sim 101$

ϕD (mm)	ϕa (mm)	ϕb (mm)	W1 (mm)	W2 (mm)
90	101.0	95.5	115.0	127.0
101	112.0	106.0	126.0	138.0

SNAP MOUNT TYPE ALUMINUM ELECTROLYTIC CAPACITORS

HOW TO ORDER

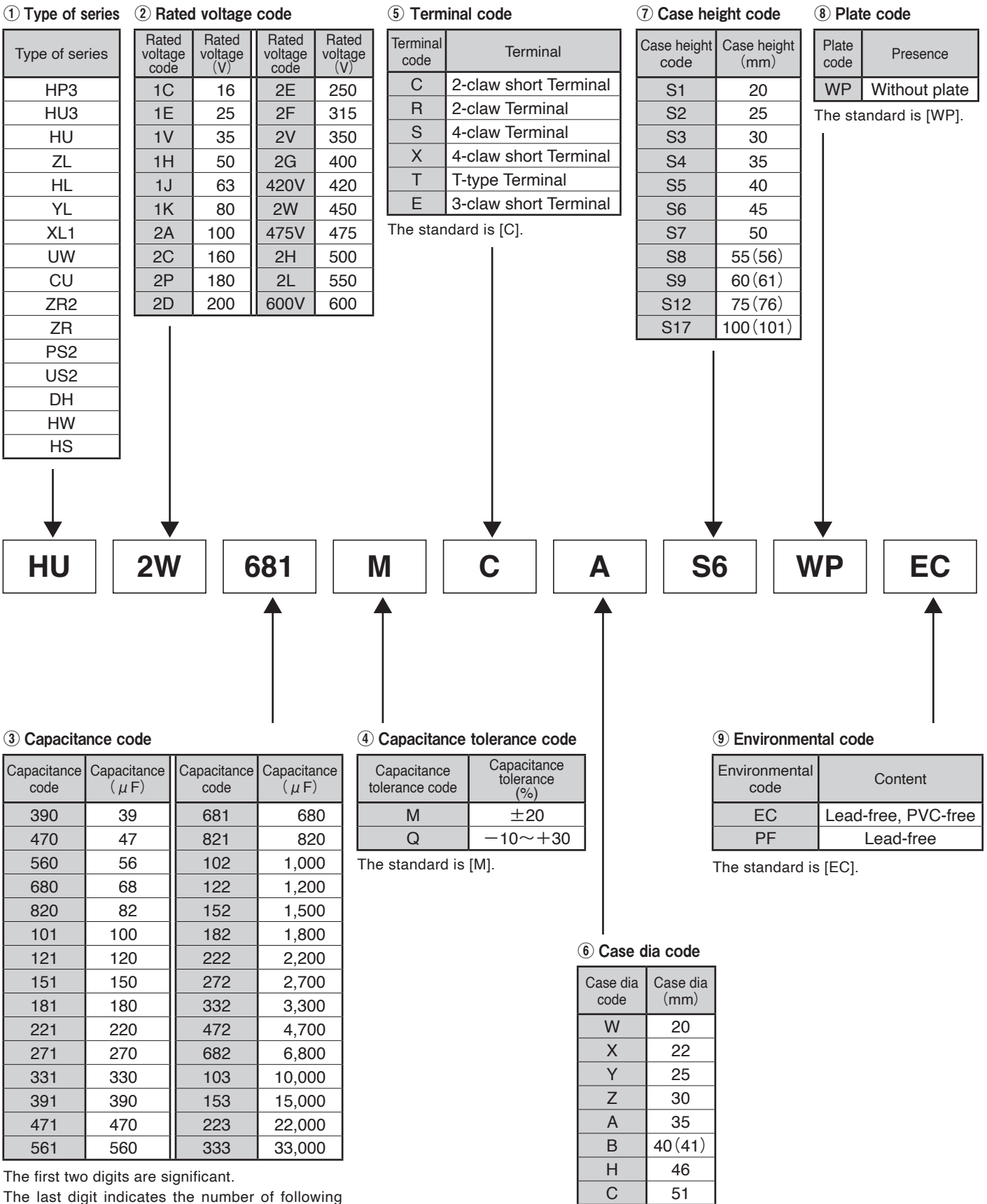

SNAP MOUNT TYPE ALUMINUM ELECTROLYTIC CAPACITORS

ALUMINUM ELECTROLYTIC CAPACITORS

OUTLINE OF DRAWINGS AND DIMENSIONS

• PS2 and US2 series use resin insulation cap. Please refer to page of each series for dimensions.

2-claw short terminal

Standard terminal

Terminal code : C

Case dia (D) : $\phi 20 \sim \phi 35$

Case height (L) : $\sim 75L$

(When fixing with the snap mount type capacitors had two claw terminal and the length of the capacitor more than 55 mm to PCB, use adhesive glue.)

(Unit : mm)

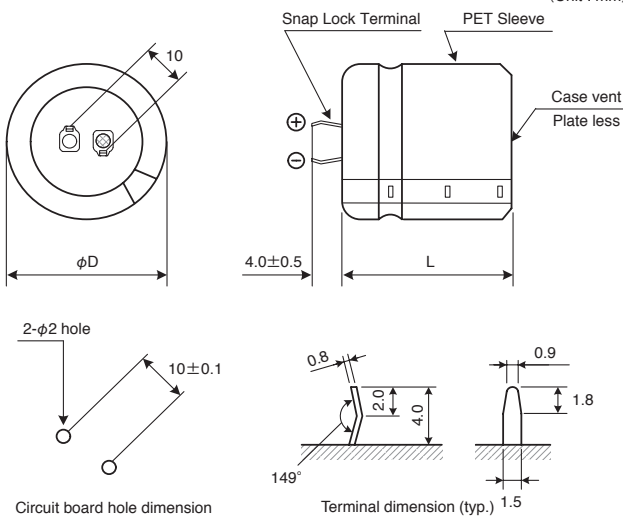

2-claw terminal

Terminal code : R

Case dia (D) : $\phi 20 \sim \phi 35$

Case height (L) : $\sim 75L$

(When fixing with the snap mount type capacitors had two claw terminal and the length of the capacitor more than 55 mm to PCB, use adhesive glue.)

(Unit : mm)

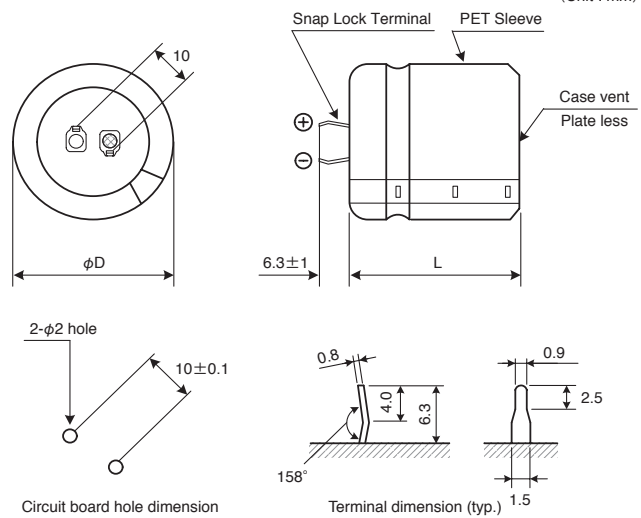

4-claw terminal

Terminal code : S

Case dia (D) : $\phi 35 \sim \phi 40$

(Unit : mm)

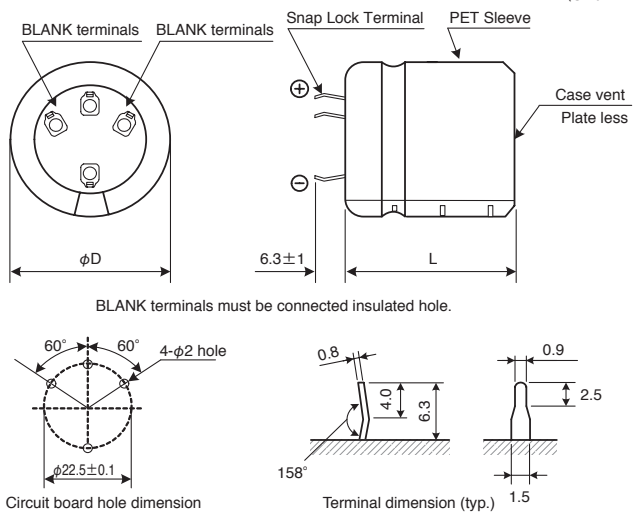

BLANK terminals must be connected insulated hole.

4-claw short terminal

Terminal code : X

Case dia (D) : $\phi 35 \sim \phi 40$

(Unit : mm)

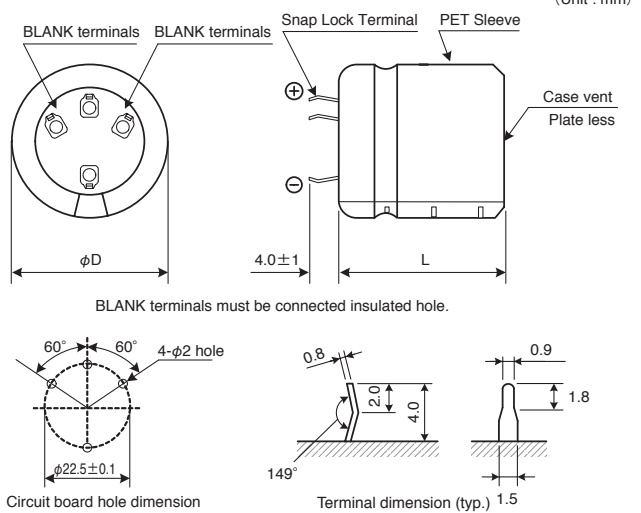

BLANK terminals must be connected insulated hole.

SNAP MOUNT TYPE ALUMINUM ELECTROLYTIC CAPACITORS

■ T-type terminal (φ 30 ~ φ 40)

Terminal code : T

Case dia (D) : φ 30 ~ φ 40

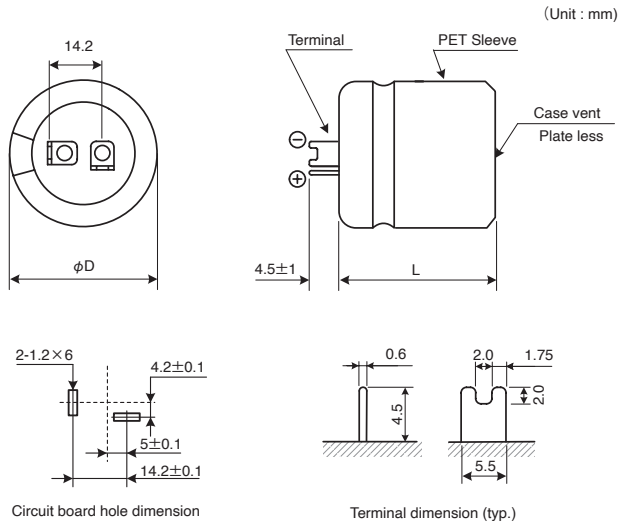

■ T-type terminal (φ 51)

Terminal code : T

Case dia (D) : φ 51

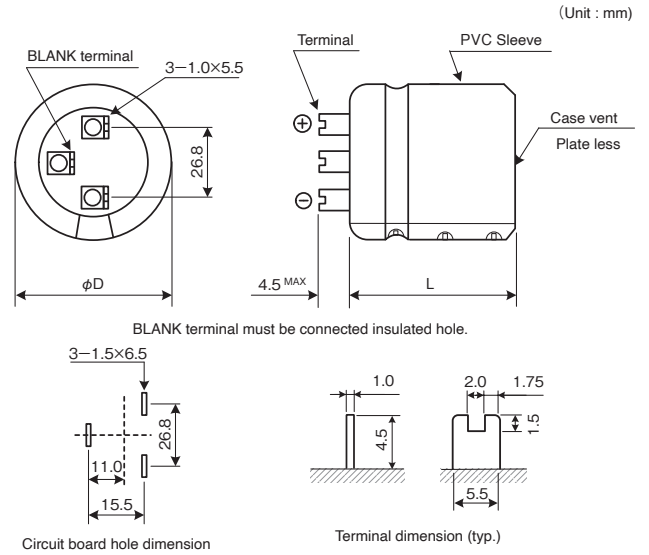

■ 3-claw short terminal

Terminal code : E

Case dia (D) : φ 22 ~ φ 35

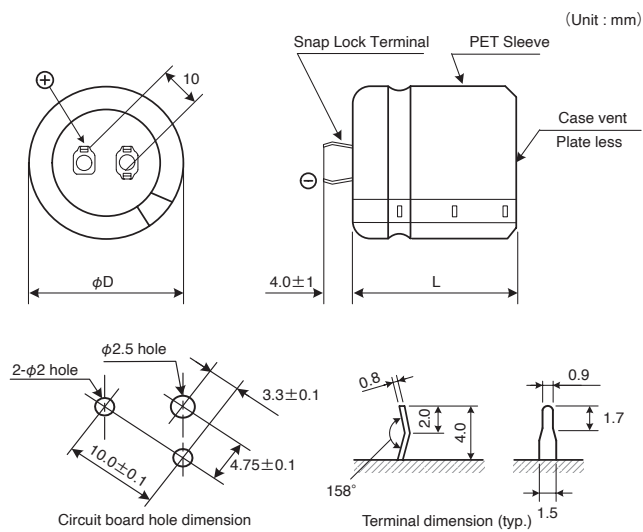

RADIAL TYPE ALUMINUM ELECTROLYTIC CAPACITORS

HOW TO ORDER

① Type of series

Type of series
HU
HL

③ Capacitance code

Capacitance code	Capacitance (μF)	Capacitance code	Capacitance (μF)
8R2	8.2	820	82
100	10	101	100
150	15	121	120
220	22	151	150
270	27	181	180
330	33	221	220
390	39	331	330
470	47	471	470
560	56	561	560
680	68		

The first two digits are significant.
The last digit indicates the number of following zeros.
ex) 680=68(μF)

⑥ Case dia code

Case dia code	Case dia (mm)
R	10
S	12.5
U	16
V	18

⑧ Environmental code

Environmental code	Content
EC	Lead-free, PVC-free

HU **2W** **680** **M** **L** **V** **25** **EC**

② Rated voltage code

Rated voltage code	Rated voltage (V)
2D	200
220V	220
2E	250
2V	350
2G	400
420V	420
2W	450

④ Capacitance tolerance code

Capacitance tolerance code	Capacitance tolerance (%)
M	±20
Q	-10~+30

The standard is [M].

⑤ Terminal code

Terminal code	Terminal
L	Lead terminal

⑦ Case height code

Case height code	Case height (mm)
16	16
20	20
25	25
315	31.5
355	35.5
40	40
45	45
50	50